

- Dimensions are in millimeters, unless stated otherwise.
- Scaling of this drawing is not recommended.
- It is the recipient's responsibility to print this document to the correct scale.
- All relevant drawings and specifications should be read in conjunction with this drawing.

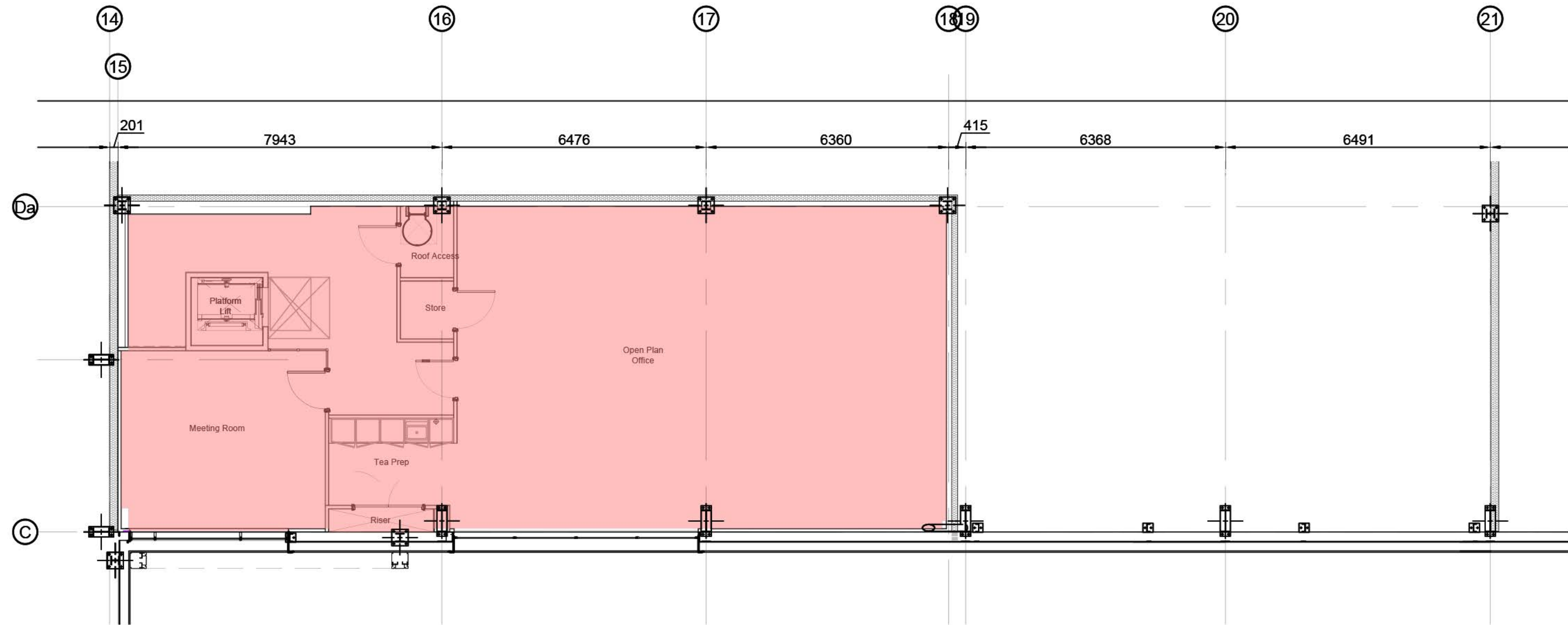

Unit 2: Production		
	sq m	sq ft
Warehouse	947	10,195
Main Office (2 Storey)	222	2,390
Total GIA	1,169	12,585

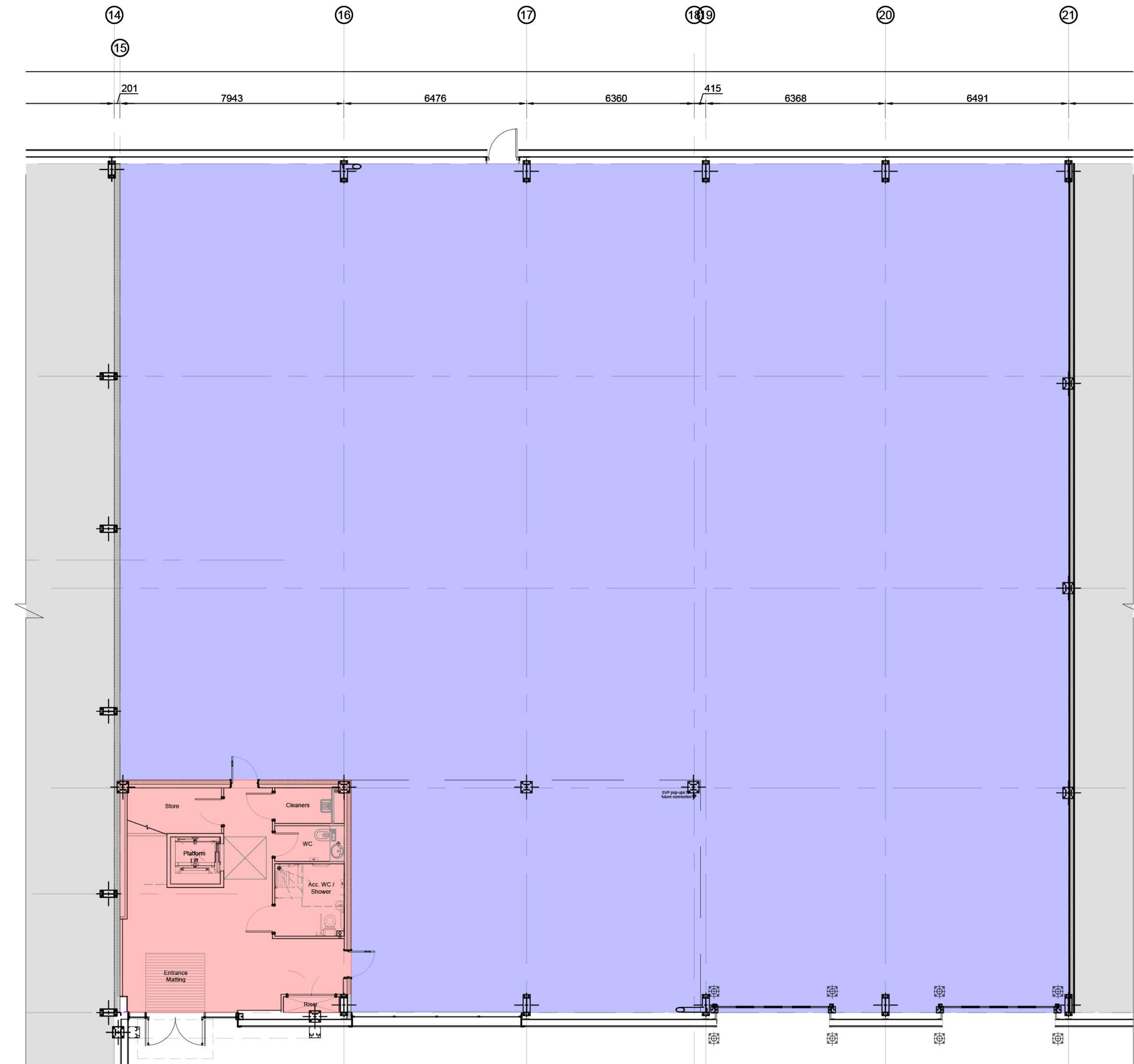

Unit 2: Warehouse		
	sq m	sq ft
Warehouse	947	10,195
Main Office (2 Storey)	222	2,390
Total GIA	1,169	12,585

B	Client comments received 05.05.22	LAH	A.J.L.	20.05.22
A	Initial Issue	LAH	A.J.L.	22.03.22
rev	amendments	by	ckd	date

Industrial Scheme, Fleet

Unit 2 - Building Layout

CAUDWELL



Newark Beacon Innovation Centre, Cafferata Way, Newark, Nottinghamshire NG24 2TN
o +44 (0)1636 653027 f +44 (0)1636 653010 e info@umcarchitects.com

Drawing Status:	Preliminary
Drawn / Checked:	LAH / MT
Date:	29.10.21
Scale:	1:100 @ A1
Drawing no:	Revision:
19203 D0017	B

Note: GIA has been calculated in accordance with RICS Code of Measuring Practice 6th Edition.

1m SCALE 1:100